



**Power Cord Access**



**Key Lock**



**Gas Struts**



Edition : 1.0  
Date: (12/24)

# Instruction Manual

## PROFESSIONAL SERIES TOP CUBBY TPS-72H

Order Code: (T6886)

## PROFESSIONAL SERIES

### BEFORE ASSEMBLING

Please read this instruction manual before assembly.



#### CAUTION

Before assembly please pay attention to the following points in priority;

**Confirmation of components:** Before assembling, please confirm all parts arrived and are in good order.

**Site for assembly:** Please assemble it on the soft floor such as smooth carpet and flannel blanket. When you assemble on wooden floor, please put thin towels on the floor.

**Points for attention when assembling:** Please wear gloves to ensure that it can be assembled safely, and use two persons to help in the assembly process.

### SAFETY INFORMATION

1. Persons other than professionals should not disassemble, repair or modify the product.
2. Keep children, infants and pregnant women away from installation places.
3. Center securely within lip on top of roller cabinet.
4. Place on top of matching roller cabinet only.
5. Do not lift while loaded.
6. Do not place objects on top or hang objects off side.
7. Evenly distribute load from bottom up. Uneven loading causes tipping. Be aware of dynamic loading! Sudden movement may briefly create excess load causing tipping.
8. Do not overload and make sure lid is closed and locked when moving.
9. Do not perform welding, hammering or disassembly work on top plate.



**CAUTION:** Do not stand on this product. You may fall which may cause personal injury or product damage.



**CAUTION:** Keep the product on level surfaces. The product may become unstable and tip if stored or moved on an un-level surface, which may cause personal injury or product damage.



**CAUTION:** Place tool chest inside inner lip on top of chest or cabinet. Make sure tool chest sits flush on roller cabinet. Only use matching roller cabinet.



**CAUTION:** Lock the hutch lid before moving this product. If Hutch lid become open it may make the product unstable and tip, which may cause personal or product damage.



**CAUTION:** Do not lift while loaded. Have assistant help place on roller cabinet while using the correct mechanical lifting aids.



### SPECIFICATIONS

Overall size: 1799 x 546 x 674 (WxDxH)

Package size: 1867 x 614 x 840 (WxDxH)

Nett Weight: 76kg

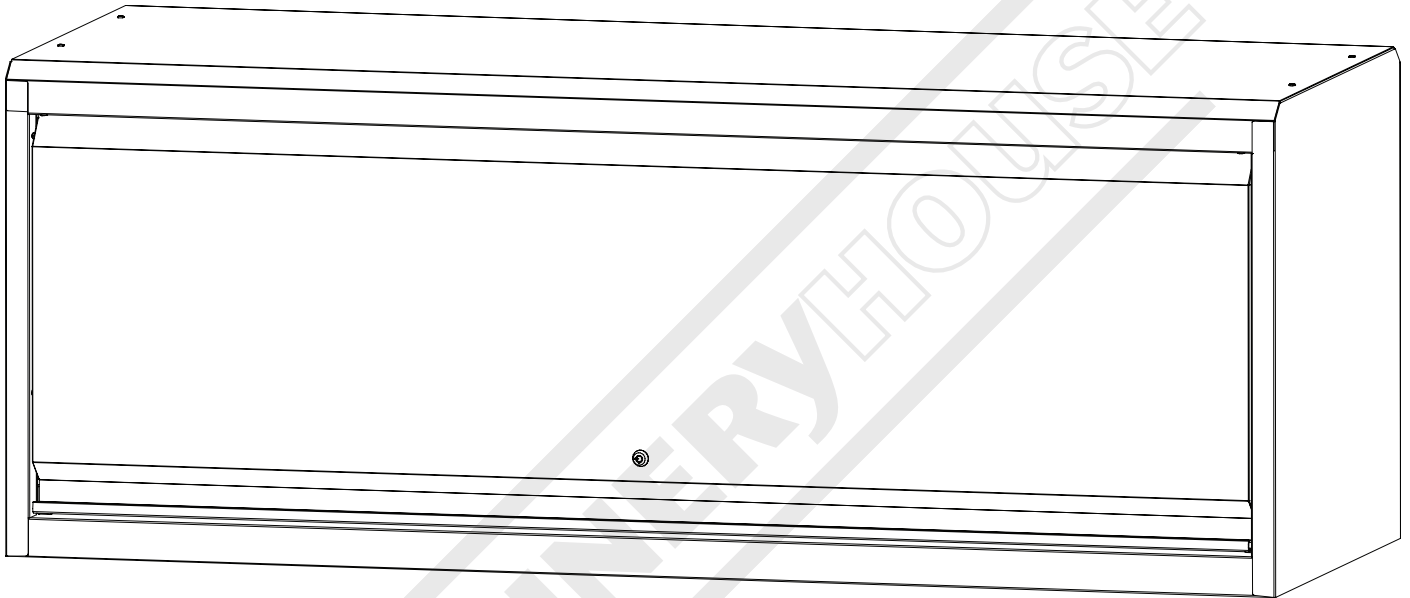

Keys (x4)



Gas Struts (x2)



Cable Access Points (x4)

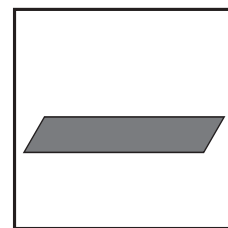

Rubber Liner (x1)

### INCLUDES

- 1 x Shelf (600 x 280 x 180mm LxWxH)
- 1 x Screwdriver Holder (370mm wide)
- 2 x Can Holders (330 x 100 x 100mm LxWxH)
- 2 x Plastic Bucket Holder Brackets (440mm wide)

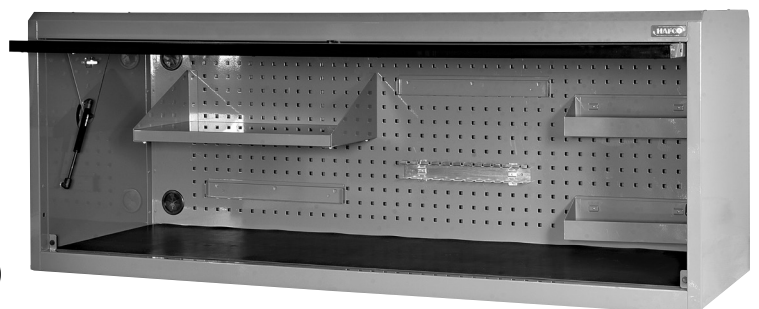

### UNPACKING INSTRUCTIONS

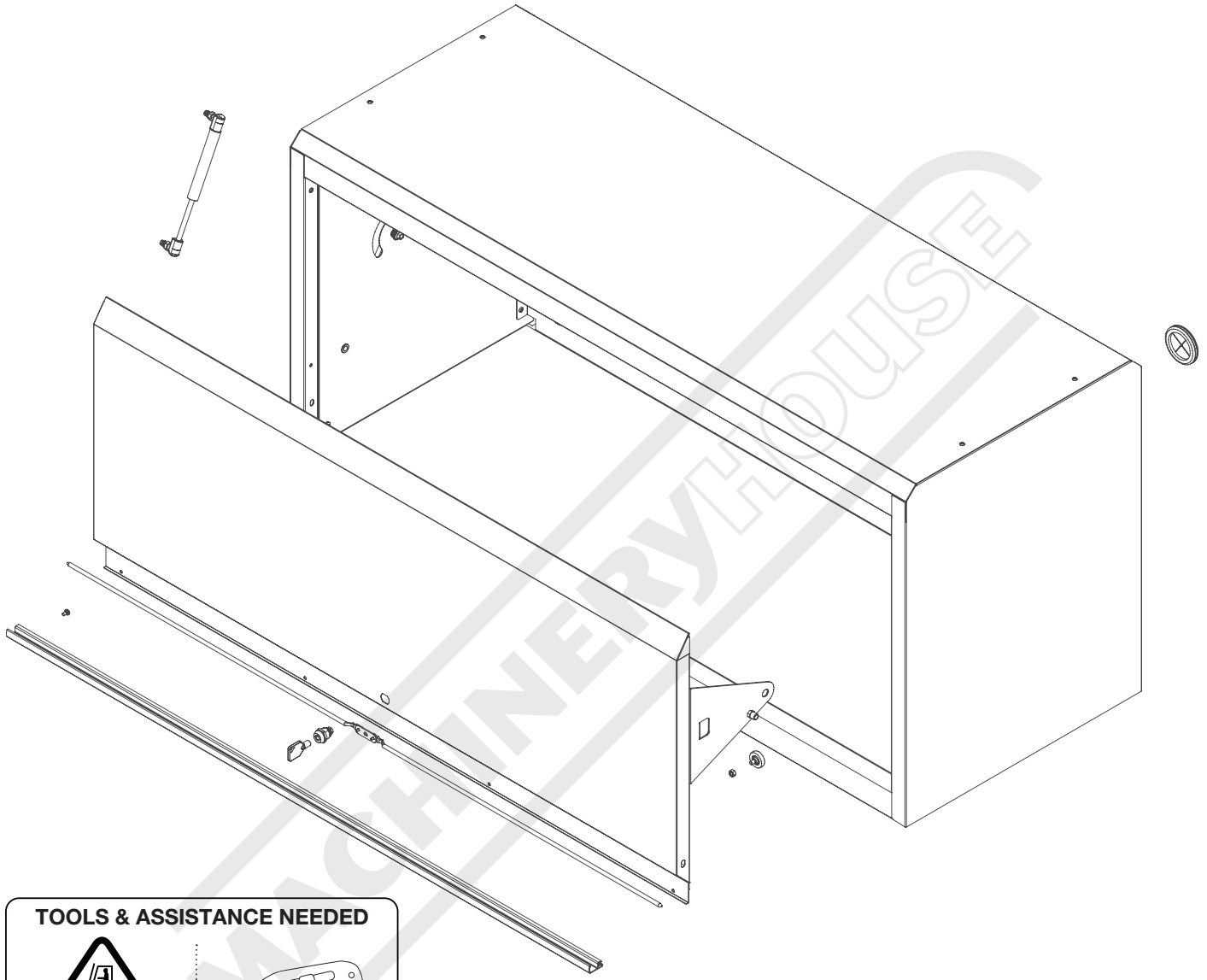

**TOOLS & ASSISTANCE NEEDED**

**OVERSIZE**  
This product requires a mechanical lifting aid.  
**WARNING**

Utility Knife

\*Tools not included



- 1. Unbox the Tool Chest:**  
Use a knife to carefully open the carton and remove the top cubby. Be cautious to avoid damaging the contents.
- 2. Unlock and Prepare:**  
Using the keys provided, unlock the top cubby. Align the foam liner inside to ensure that it is properly positioned.
- 3. Lifting and Positioning:**  
The top cubby weighs 76kg, so it is important to use proper lifting techniques. Ensure you have assistance or appropriate lifting equipment to move it into its final position.





#### **ENVIRONMENT PROTECTION**

Recycle unwanted materials instead of disposing of them as waste. All tools, accessories and packaging should be sorted, taken to a recycling centre and disposed of in a manner which is compatible with the environment. When the product becomes completely unserviceable and requires disposal, drain any fluids (if applicable) into approved containers and dispose of the product and fluids according to local regulations.

Imported by

**HARE & FORBES**  
**MACHINERYHOUSE**

**Australian Distributor**

Hare & Forbes  
Machineryhouse  
Sydney - Melbourne  
Adelaide - Brisbane - Perth

Ph: 1300 202 200  
[www.machineryhouse.com.au](http://www.machineryhouse.com.au)

**MACHINERYHOUSE**

**New Zealand Distributor**

Machineryhouse  
Auckland  
Christchurch

Ph: 0800 142 326  
[www.machineryhouse.co.nz](http://www.machineryhouse.co.nz)